

PA892900CA2

HumaPen[®] Ergo

CM14MAY03



For use only with Humalog[®] or Humulin[®] 3 mL Insulin Cartridges (100 IU/mL)
Your **HumaPen[®] Ergo** may be a different color from the model shown, but it will work the same way.

HumaPen[®] Ergo Pen Parts

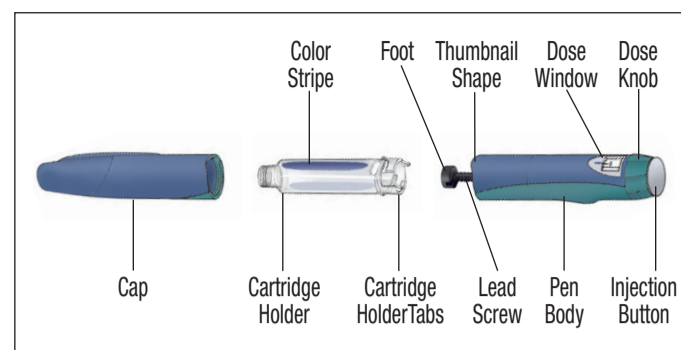

Pen Needle* and Insulin Cartridge* *sold separately

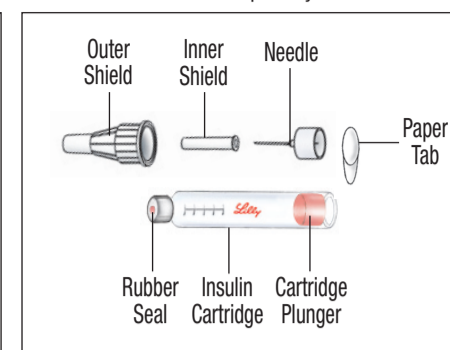

Introduction

The **HumaPen[®] Ergo** is designed for ease of use. You can inject from 1 to 60 units of any Humulin[®] or Humalog[®] insulin from a 3 mL cartridge (100 IU/mL). You can dial your dose one unit at a time. If you dial too many units, you can correct the dose without wasting any insulin.

Read this entire manual completely and follow the directions carefully before using the pen. Failure to follow the instructions may result in a wrong insulin dose. If any of the parts of your **HumaPen[®] Ergo appear broken or damaged, DO NOT USE. Contact Lilly at 1-888-545-5972 or your healthcare professional for a replacement pen.**

Important Notes

The **HumaPen[®] Ergo** is a pen for giving accurate insulin injections. **It is important that you read and understand all of the safety information before giving injections.** Keep these directions for future reference.

- Always prime (check insulin flow) before each injection. **Do not use** the pen if insulin does not flow after priming. Priming is important. If you do not prime until insulin comes out you could get a wrong insulin dose. See the question, **Why doesn't insulin come out when I prime the pen**, in the **Questions and Answers** section for more information.
- Make sure that the cartridge holder is completely and securely attached to the pen body before each injection. If the cartridge holder is not correctly attached, you could get a wrong insulin dose.
- Do not use** the pen if any part of your pen appears broken or damaged. Contact Lilly at 1-888-545-5972 or your healthcare professional.
- The **HumaPen[®] Ergo** is not recommended for the blind or visually impaired without the assistance of a sighted individual trained to use it.
- Always carry a spare insulin delivery device in case your pen is lost or damaged.

Insulin

- Your healthcare professional has prescribed the type of insulin best for you. Any changes in insulin should be made only under medical supervision.
- The **HumaPen[®] Ergo** is for use only with Humalog[®] or Humulin[®] 3 mL insulin cartridges.
- Do not use other brands of insulin cartridges or 1.5 mL cartridges.**
- Read and follow the instructions provided with your Humalog[®] or Humulin[®] 3 mL insulin cartridges.
- Before each injection, always check the appearance of the insulin through the cartridge holder and be sure the pen contains the correct Humalog[®] or Humulin[®] 3 mL insulin cartridge. The color of the pen is not intended to indicate insulin type.
- For more information on **HumaPen[®] Ergo** and Humalog[®] or Humulin[®] insulin, please visit our website at www.lilly.ca.

Needles

- HumaPen[®] Ergo** is suitable for use with Becton, Dickinson and Company insulin pen needles.
- It will be easier to push the injection button if you use a 29 gauge needle.
- Do not share your pen and needles.
- The directions regarding needle handling are not intended to replace local, healthcare professional or institutional policies.
- Use a new needle for each injection.
- Remove the needle after completing each injection. Do not store the pen with the needle attached.

Injecting

- Do not attempt to inject your insulin by *turning* the dose knob. You will NOT receive your insulin by turning the dose knob. **You must PUSH the injection button straight down for the dose to be delivered.**
- Do not push the injection button unless a needle is attached to the pen.
- Do not attempt to change the dose while injecting.
- Use a new needle for each injection. This will help ensure sterility and prevent leakage, reentry of air, and potential needle clogs.

Care and Storage

- Keep the pen away from moisture, dust, extreme hot or cold temperatures and direct sunlight.
- Do not damage or remove cartridge holder tabs.
- Do not use the pen if the cartridge holder tabs are broken. Contact your healthcare professional for a replacement pen.
- Do not store the pen in the refrigerator.
- Wipe the pen cap, pen body and case with a damp cloth to clean it. Do not use alcohol on the pen body or dose window.
- Do not use bleach, immerse (cover) in liquid, apply oil or other lubrication, since this could damage the pen.
- Your injection button may become harder to push if the inside of your pen gets dirty with insulin, food, drink or other materials.

Replacement

- Your **HumaPen[®] Ergo** has been designed to be used for up to 3 years after first use. Record the date your pen was first used here: ___ / ___ / ___. Contact your healthcare professional to get a new **HumaPen[®] Ergo** when your pen has been used for 3 years.

Questions and Answers

Priming

Why is priming important?

Priming fills any empty spaces inside the needle or cartridge with insulin and checks that insulin will flow out of your pen when you inject. You may need to prime once or repeat several times to get the insulin flowing out of the needle. Always prime to be sure insulin is flowing after changing a cartridge and before each injection. **If you do not prime until insulin comes out, you could get a wrong insulin dose.**

Why doesn't insulin come out when I prime the pen?

The needle may be clogged, the cartridge holder may not be completely attached, or the foot of the lead screw may not be against the cartridge plunger. You may not be able to see the foot of the lead screw, but repeating the priming step will move it to touch the plunger. The foot of the lead screw pushes the cartridge plunger forward, and insulin will come out.

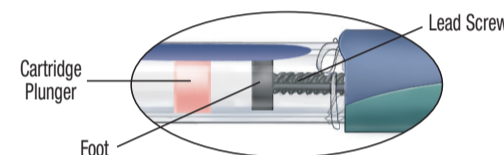

Make sure the foot of the lead screw is against the cartridge plunger as shown below.

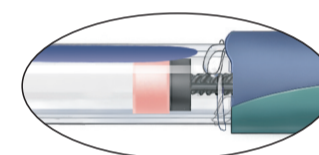

- Repeat the priming step until insulin flow is seen (see step 7 on reverse side).
- If there is no insulin flow after several attempts, hold the pen with the needle facing upwards and away from your face. Attach a new needle.
- Repeat the priming step until insulin flow is seen.**
- If you are still unable to get insulin flowing out of the needle, do not use the pen. Return the pen to your healthcare professional to obtain a replacement pen.

What should I do if I have an air bubble in the cartridge after I prime?

Hold the pen with the needle facing upwards, tap the insulin cartridge holder gently with your finger so any air bubbles can collect near the top. Repeat the priming step. A small air bubble may remain in the cartridge after the completion of the priming step. If you have properly primed the pen, this small air bubble will not affect your insulin dose.

Loading and Injecting

How can I check that my cartridge holder is attached properly?

The color stripe on the cartridge holder will line up with the thumbnail shape on the pen body, as shown in step 4.

Why does insulin come out when I dial backwards?

The injection button may have been accidentally pushed when dialing backwards. To avoid this, do not push the injection button when dialing backwards, and only push the injection button when injecting.

Why doesn't the dose knob go to zero when I inject my dose?

Your cartridge may not have had enough insulin for your entire dose. The number in the dose window is the amount you did **not receive**. To get the rest of your dose, remove needle, change insulin cartridge as shown on reverse side (**Changing Insulin Cartridge**), and perform steps 4-12 injecting only the dose amount you did not receive.

Frequently Asked Questions

Why doesn't the lead screw move forward when the cartridge holder is not attached?

The lead screw will not move forward unless the cartridge holder is completely attached and the cartridge holder tabs are locked in place. If the cartridge holder is not completely attached, the lead screw will not move forward and no insulin will be delivered. Do not use the pen if the tabs are broken, and contact Lilly at 1-888-545-5972 or your healthcare professional for a replacement.

When I try to inject, why is it difficult to push down the injection button?

- Pressing the injection button down quickly may make the button harder to push. Pressing the button more slowly may make it easier.
- Pressing on the side of the injection button may make it harder to inject. Be sure to press straight down on the injection button (as shown in step 10).
- Using a 29 gauge needle will make it easier to push the injection button. You can use a 30 or 31 gauge needle, but it will make it harder to push the injection button. See your healthcare professional to determine which gauge needle is best for you.
- The injection button may become harder to push if foreign material (dirt, dust), insulin, or other liquids get inside the pen. Replace the pen if the injection button gets too hard to push.

If you have any questions or problems with your **HumaPen[®] Ergo, contact Lilly at 1-888-545-5972 or your healthcare professional for assistance.**

HumaPen® Ergo, Insulin Cartridge* and Needle* Assembly

* sold separately

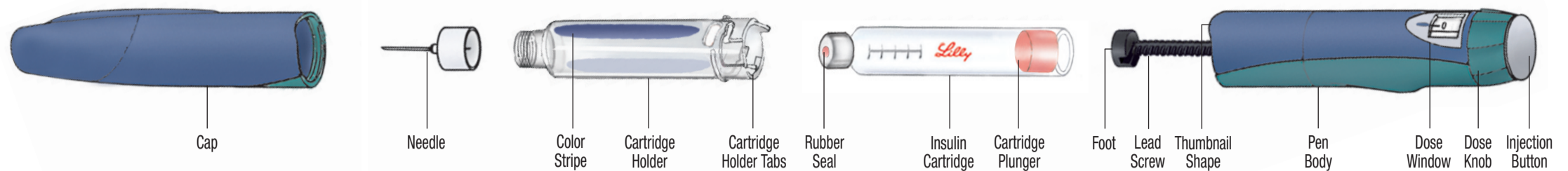

Operating Instructions – Loading an Insulin Cartridge

1 Remove Cap

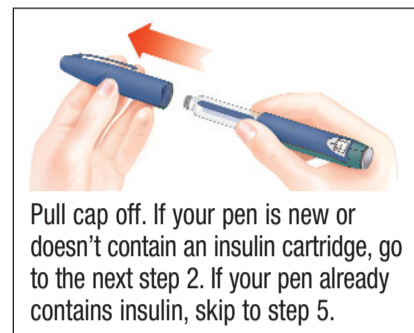

Pull cap off. If your pen is new or doesn't contain an insulin cartridge, go to the next step 2. If your pen already contains insulin, skip to step 5.

2 Remove Cartridge Holder

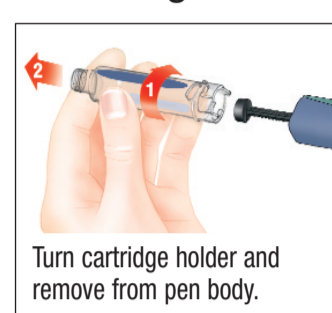

Turn cartridge holder and remove from pen body.

3 Insert Insulin Cartridge

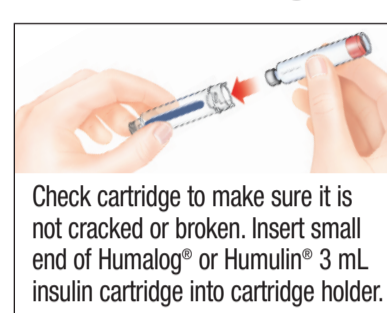

Check cartridge to make sure it is not cracked or broken. Insert small end of Humalog® or Humulin® 3 mL insulin cartridge into cartridge holder.

4 Attach Cartridge Holder

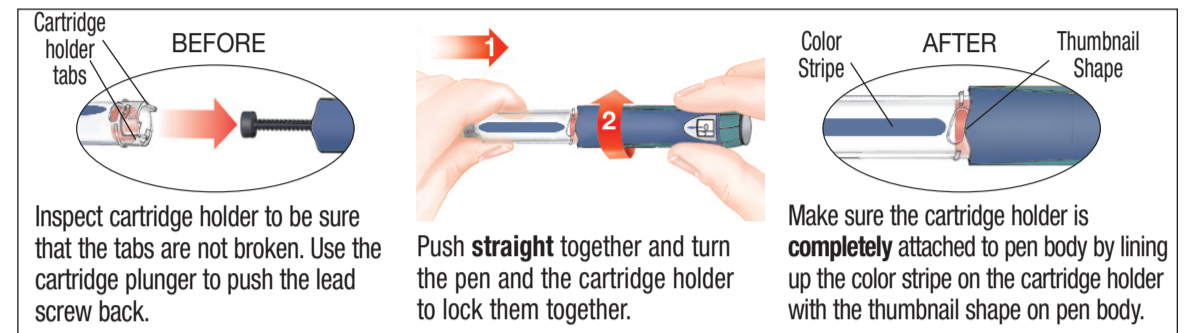

Inspect cartridge holder to be sure that the tabs are not broken. Use the cartridge plunger to push the lead screw back.

Push **straight** together and turn the pen and the cartridge holder to lock them together.

Make sure the cartridge holder is **completely** attached to pen body by lining up the color stripe on the cartridge holder with the thumbnail shape on pen body.

Operating Instructions – Preparing and Injecting Insulin

5 Prepare & Inspect Insulin

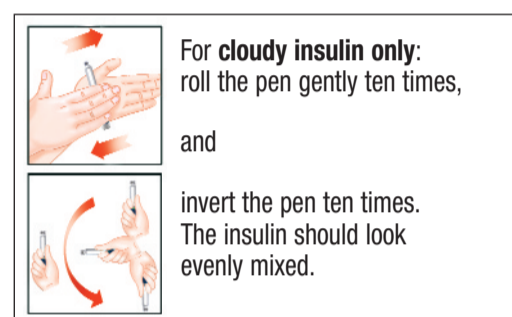

For **cloudy insulin only**: roll the pen gently ten times, and invert the pen ten times. The insulin should look evenly mixed.

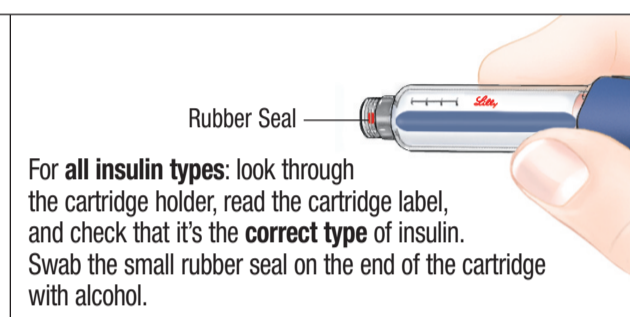

For **all insulin types**: look through the cartridge holder, read the cartridge label, and check that it's the **correct type** of insulin. Swab the small rubber seal on the end of the cartridge with alcohol.

6 Attach Needle

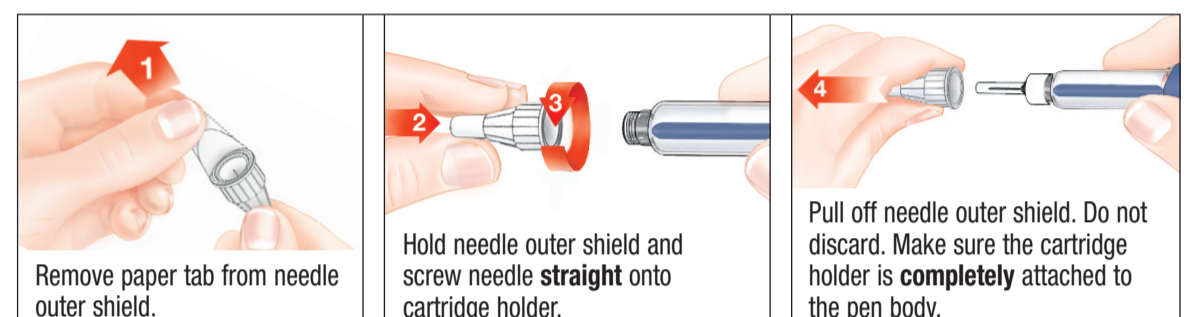

Remove paper tab from needle outer shield.

Hold needle outer shield and screw needle **straight** onto cartridge holder.

Pull off needle outer shield. Do not discard. Make sure the cartridge holder is **completely** attached to the pen body.

7 Prime (Check Insulin Flow)

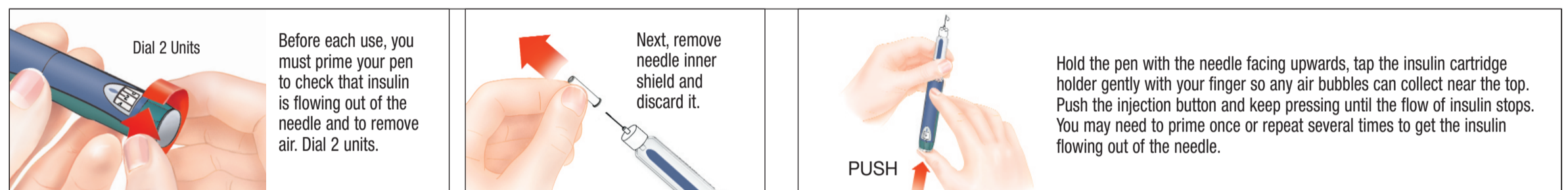

Dial 2 Units

Before each use, you must prime your pen to check that insulin is flowing out of the needle and to remove air. Dial 2 units.

Next, remove needle inner shield and discard it.

PUSH

Hold the pen with the needle facing upwards, tap the insulin cartridge holder gently with your finger so any air bubbles can collect near the top. Push the injection button and keep pressing until the flow of insulin stops. You may need to prime once or repeat several times to get the insulin flowing out of the needle.

Caution: If insulin does not appear, repeat the priming step until insulin flow is seen. If you do not prime until insulin comes out, you could get a wrong insulin dose. Refer to the *Questions and Answers* section on the reverse side of this manual for more information.

8 Dial Your Dose

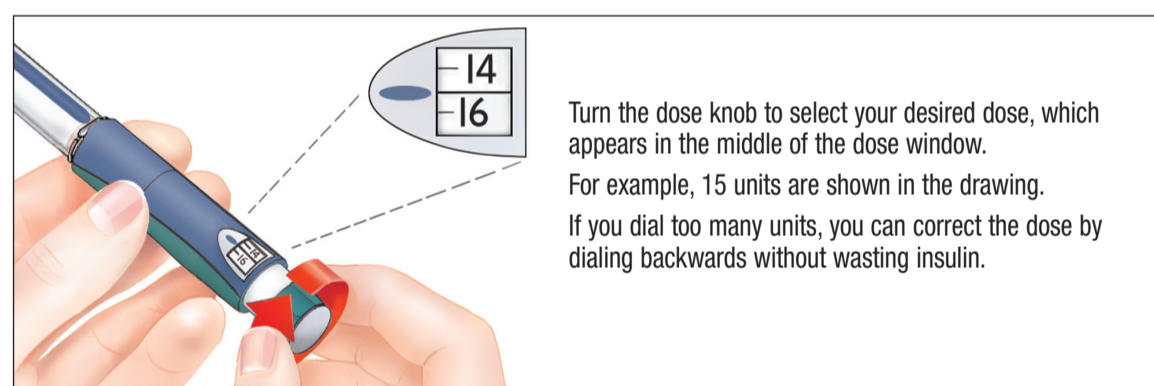

Turn the dose knob to select your desired dose, which appears in the middle of the dose window. For example, 15 units are shown in the drawing. If you dial too many units, you can correct the dose by dialing backwards without wasting insulin.

9 Insert Needle

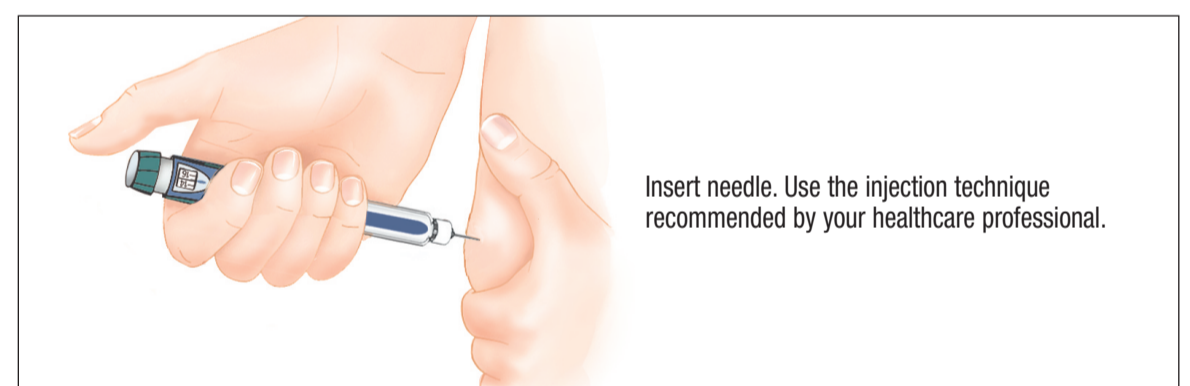

Insert needle. Use the injection technique recommended by your healthcare professional.

10 Inject Your Dose

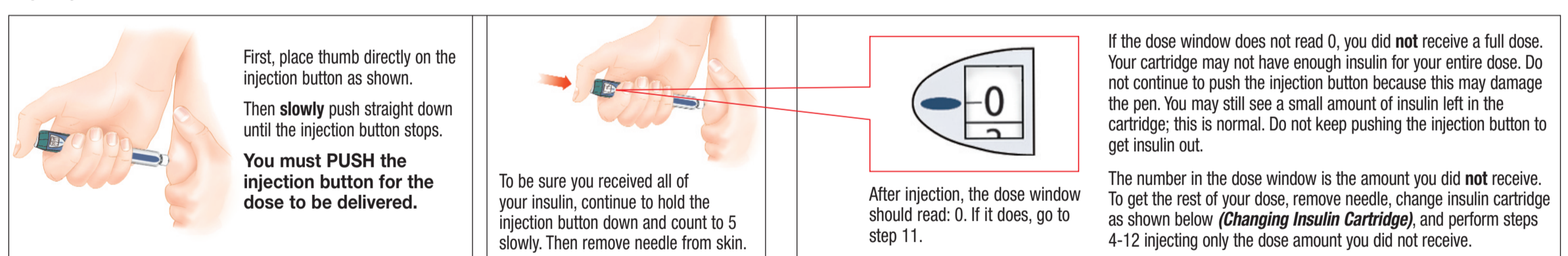

First, place thumb directly on the injection button as shown. Then **slowly** push straight down until the injection button stops.

You must PUSH the injection button for the dose to be delivered.

To be sure you received all of your insulin, continue to hold the injection button down and count to 5 slowly. Then remove needle from skin.

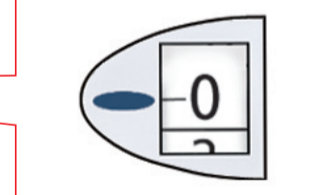

After injection, the dose window should read: 0. If it does, go to step 11.

If the dose window does not read 0, you did **not** receive a full dose. Your cartridge may not have enough insulin for your entire dose. Do not continue to push the injection button because this may damage the pen. You may still see a small amount of insulin left in the cartridge; this is normal. Do not keep pushing the injection button to get insulin out.

The number in the dose window is the amount you did **not** receive. To get the rest of your dose, remove needle, change insulin cartridge as shown below (**Changing Insulin Cartridge**), and perform steps 4-12 injecting only the dose amount you did not receive.

11 Remove Needle

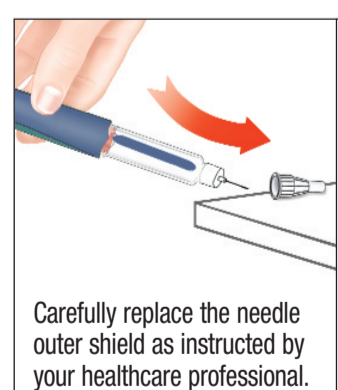

Carefully replace the needle outer shield as instructed by your healthcare professional.

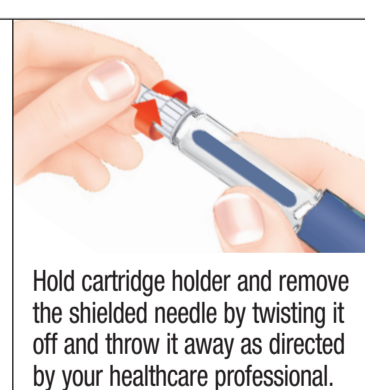

Hold cartridge holder and remove the shielded needle by twisting it off and throw it away as directed by your healthcare professional.



Push cap on pen.

12 Replace Cap

Operating Instructions – Changing Insulin Cartridge

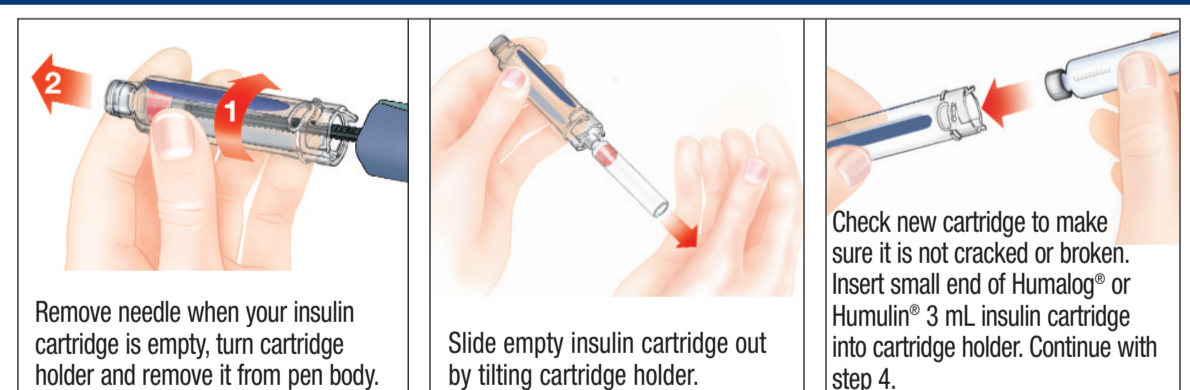

Remove needle when your insulin cartridge is empty, turn cartridge holder and remove it from pen body.

Slide empty insulin cartridge out by tilting cartridge holder.

Check new cartridge to make sure it is not cracked or broken. Insert small end of Humalog® or Humulin® 3 mL insulin cartridge into cartridge holder. Continue with step 4.

If you have any questions or problems with your **HumaPen® Ergo**, contact Lilly at 1-888-545-5972 or your healthcare professional for assistance.

Eli Lilly Canada Inc.
3650 Danforth Avenue
Toronto, Ontario
M1N 2E8

Manufactured by: Eli Lilly and Company
Pharmaceutical Delivery Systems
Lilly Corporate Center
Indianapolis, IN 46285, USA

Packaged by: Lilly Pharma Fertigung und
Distribution GmbH & Co. KG
35387 Giessen, Germany

Authorized Representative
in the EU:

Eli Lilly and Company Ltd.
Erl Wood Manor, Windlesham, Surrey
GU20 6PH UK

CE
0336

† Humalog®, Humulin®, **HumaPen®**, **HumaPen® Ergo**, and script hand design are trademarks of Eli Lilly and Company.

Patent pending for **HumaPen®**.

© 2003, Eli Lilly and Company. All rights reserved.

The **HumaPen® Ergo** meets the current dose accuracy and functional requirements of ISO 11608-1:2000 with Lilly 3 mL cartridges.

PA8929000CA2

Lilly